

DATE: 01-29-15
SCALE: 1" = 120' - 0"

GENERAL NOTES:

- ALL ZONES ARE MARKED ON THE ROAD AND AT THE EAST END.
- ARROWS INDICATE THE DIRECTION OF THE NUMBERS.
- PERFORMED BY:
A Cut Above Tree Care & Landscape, Inc.
CERTIFIED ARBORIST, FL 6215A
JAN., 2015.

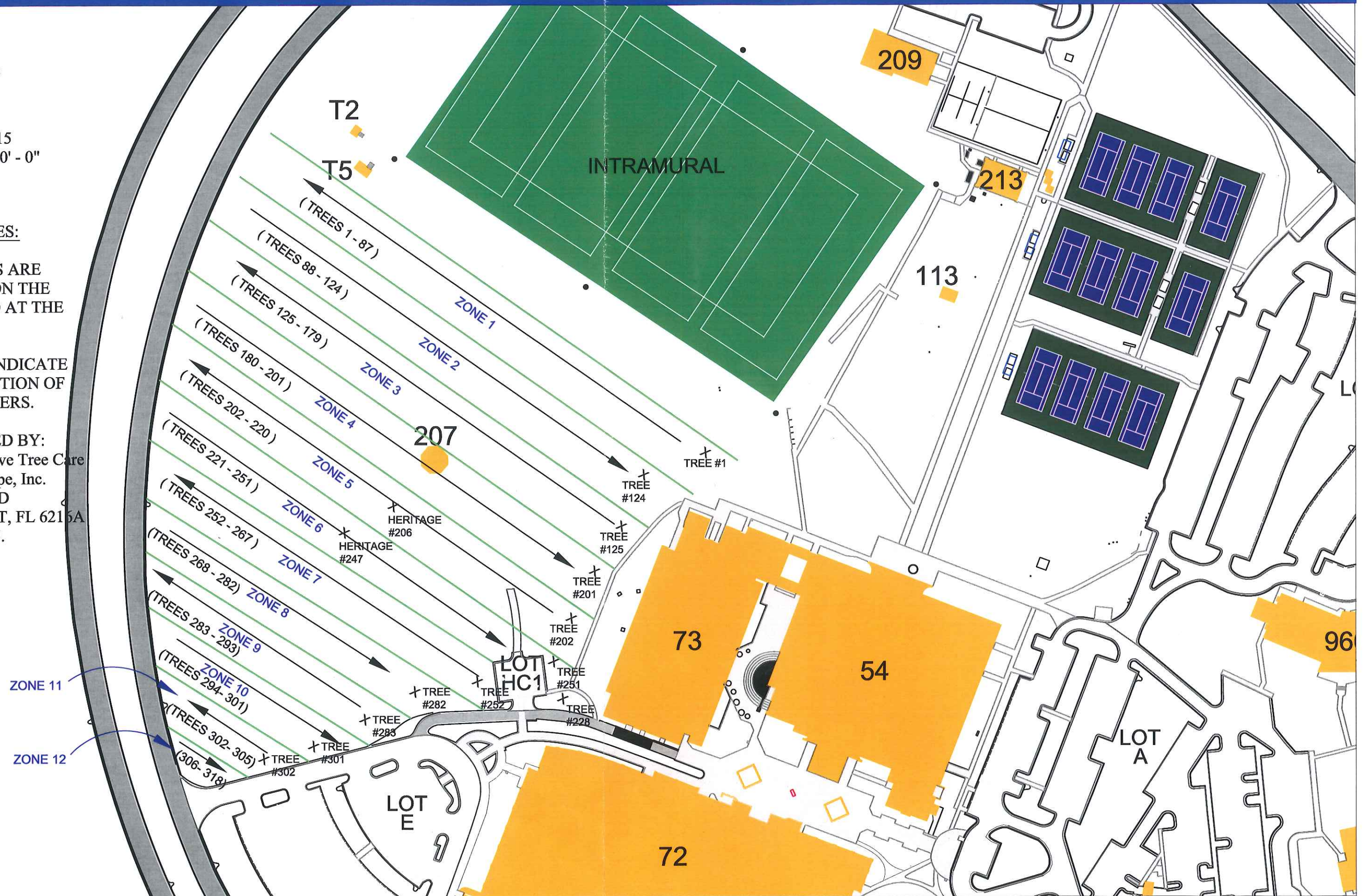

UWF Tree Inventory Report

ZONE 1 (Northern perimeter trees remaining)					
Northern perimeter trees remaining: not affected in stadium project					
Number	Species	Common Name	DBH 4 1/2'	Condition	Notes:
1	quercus virginiana	Live oak	11	Viable	
2	pinus taeda	Loblolly pine	11	Viable	
3	pinus taeda	Loblolly pine	16	Viable	
4	quercus laurifolia	Laurel	11	Viable	
5	quercus laurifolia	Laurel	9	Viable	
6	quercus virginiana	Live oak	13	Viable	remain
7	quercus laurifolia	Laurel	11	Viable	remain
8	pinus taeda	Loblolly pine	15	Viable	remain
9	pinus taeda	Loblolly pine	12	Viable	remain
10	quercus laurifolia	Laurel	10	Viable	remain
11	quercus laurifolia	Laurel	16	Viable	remain
12	quercus virginiana	Live oak	22	Viable	remain
13	quercus laurifolia	Laurel	21	Non viable	remain
14	quercus laurifolia	Laurel	9	Viable	remain
15	quercus laurifolia	Laurel	11	Non viable	remain
16	quercus laurifolia	Co-dominant laurel	23	Viable	
17	quercus nigra	Water oak	8	Non viable	
18	pinus taeda	Loblolly pine	13	Viable	
19	pinus taeda	Loblolly pine	11	Viable	
20	quercus laurifolia	Laurel	15	Viable	
21	quercus laurifolia	Laurel	9	Viable	
22	quercus laurifolia	Laurel	14	Non viable	
23	quercus laurifolia	Laurel	10	Non viable	
24	quercus laurifolia	Laurel	9	Non viable	
25	quercus laurifolia	Laurel	11	Viable	
26	pinus taeda	Loblolly pine	10	Viable	
27	quercus laurifolia	Laurel	8	Viable	
28	pinus taeda	Loblolly pine	15	Viable	
29	quercus laurifolia	Laurel	11	Non viable	
30	quercus laurifolia	Laurel	12	Viable	
31	pinus taeda	Loblolly pine	10	Viable	
32	pinus taeda	Loblolly pine	9	Viable	
33	pinus taeda	Loblolly pine	15	Viable	
34	pinus taeda	Loblolly pine	19	Non viable	
35	quercus laurifolia	Laurel	10	Viable	
36	quercus laurifolia	Laurel	13	Non viable	
37	quercus virginiana	Live oak	17	Viable	
38	pinus taeda	Loblolly pine	15	Viable	
39	pinus taeda	Loblolly pine	8	Viable	
40	pinus taeda	Loblolly pine	9	Viable	
41	quercus laurifolia	Laurel	9	Viable	

Presented by: A Cut Above Tree Care

David Bradford

ISA Certified Arborist

UWF Tree Inventory Report

42	quercus nigra	Water oak	9	Viable	
43	quercus laurifolia	Laurel	12	Viable	
44	quercus laurifolia	Laurel	10	Non viable	
45	quercus virginiana	Live oak	14	Viable	
46	quercus virginiana	Co-dominant live oak	15	Viable	
47	quercus virginiana	Live oak	11	Viable	
48	quercus laurifolia	Laurel	8	Non viable	
49	quercus laurifolia	Laurel	9	Viable	
50	pinus taeda	Loblolly pine	11	Viable	
51	quercus laurifolia	Laurel	8	Viable	
52	quercus virginiana	Live oak	10	Viable	
53	quercus laurifolia	Laurel	8	Viable	
54	quercus laurifolia	Laurel	11	Viable	
55	pinus taeda	Loblolly pine	10	Viable	
56	quercus laurifolia	Laurel	9	Viable	
57	quercus laurifolia	Laurel	10	Viable	
58	quercus laurifolia	Laurel	9	Viable	
59	quercus nigra	Water oak	14	Viable	
60	quercus laurifolia	Laurel	10	Viable	
61	pinus taeda	Loblolly pine	9	Viable	
62	quercus virginiana	Live oak	19	Viable	
63	quercus laurifolia	Laurel	9	Viable	
64	quercus laurifolia	Laurel	13	Viable	
65	pinus taeda	Loblolly pine	19	Viable	remain
66	quercus laurifolia	Laurel	10	Viable	remain
67	quercus virginiana	Live oak	10	Viable	remain
68	quercus virginiana	Live oak	9	Viable	remain
69	quercus laurifolia	Laurel	8	Viable	remain
70	pinus taeda	Loblolly pine	20	Viable	remain
71	quercus falcata	Southern red oak	11	Viable	remain
72	pinus taeda	Loblolly pine	12	Viable	remain
73	quercus laurifolia	Laurel	11	Viable	remain
74	quercus laurifolia	Laurel	20	Viable	remain
75	quercus virginiana	Live oak	8	Viable	remain
76	pinus taeda	Loblolly pine	10	Viable	remain
77	quercus falcata	Southern red oak	21	Viable	remain
78	quercus laurifolia	Laurel	11	Viable	remain
79	pinus taeda	Loblolly pine	12	Viable	remain
80	pinus taeda	Loblolly pine	16	Viable	remain
81	pinus taeda	Loblolly pine	13	Viable	remain
82	quercus virginiana	Live oak	14	Viable	remain
83	carya tomentosa	Hickory	8	Viable	remain
84	quercus virginiana	Live oak	13	Viable	remain
85	quercus nigra	Water oak	12	Non viable	remain

Presented by: A Cut Above Tree Care

David Bradford

ISA Certified Arborist

UWF Tree Inventory Report

86	quercus laurifolia	Laurel	8	Non viable	remain
87	carya tomentosa	Hickory	11	Viable	remain
ZONE 2					
Number	Species	Common Name	DBH 4 1/2'	Condition	Notes:
88	pinus taeda	Loblolly pine	14	Viable	remain
89	carya tomentosa	Hickory	13	Viable	remain
90	pinus taeda	Loblolly pine	14	Viable	remain
91	pinus taeda	Loblolly pine	15	Viable	remain
92	quercus falcata	Southern red oak	9	Viable	remain
93	acer rubrum	Red maple	8	Viable	
94	magnolia grandiflora	Southern magnolia	13	Viable	
95	magnolia grandiflora	Southern magnolia	9	Viable	remain
96	pinus taeda	Loblolly pine	12	Viable	remain
97	quercus virginiana	Live oak	20	Non viable	
98	carya tomentosa	Co-dominant Hickory	13	Viable	
99	pinus taeda	Loblolly pine	16	Viable	
100	magnolia grandiflora	Southern magnolia	9	Viable	
101	pinus taeda	Loblolly pine	13	Viable	
102	quercus laurifolia	Laurel	12	Non viable	
103	quercus virginiana	Live oak	34	Viable	
104	quercus laurifolia	Laurel	12	Non viable	
105	pinus taeda	Loblolly pine	10	Viable	
106	pinus taeda	Loblolly pine	10	Viable	
107	pinus taeda	Loblolly pine	10	Viable	
108	pinus taeda	Loblolly pine	13	Viable	
109	quercus laurifolia	Laurel	15	Viable	
110	quercus laurifolia	Laurel	20	Viable	
111	quercus laurifolia	Laurel	13	Viable	
112	quercus laurifolia	Laurel	19	Non viable	
113	quercus laurifolia	Laurel	12	Non viable	
114	quercus laurifolia	Laurel	10	Non viable	
115	quercus laurifolia	Laurel	14	Non viable	
116	quercus laurifolia	Laurel	15	Non viable	
117	quercus virginiana	Live oak	17	Viable	remain
118	quercus laurifolia	Laurel	8	Viable	remain
119	quercus laurifolia	Laurel	15	Viable	remain
120	quercus laurifolia	Laurel	9	Non viable	remain
121	quercus laurifolia	Laurel	12	Viable	remain
122	quercus laurifolia	Co-dominant laurel	17	Viable	remain
123	quercus laurifolia	Laurel	12	Non viable	
124	quercus laurifolia	Laurel	11	Non viable	
ZONE 3					

Presented by: A Cut Above Tree Care

David Bradford

ISA Certified Arborist

1/20/2015

UWF Tree Inventory Report

Number	Species	Common Name	DBH 4 1/2'	Condition	Notes:
125	pinus taeda	Loblolly pine	18	Viable	
126	quercus virginiana	Live oak	25	Non viable	
127	quercus laurifolia	Laurel	11	Viable	
128	quercus laurifolia	Laurel	10	Viable	remain
129	quercus virginiana	Live oak	37	Viable	remain
130	quercus virginiana	Live oak	27	Viable	remain
131	quercus virginiana	Live oak	23	Viable	
132	quercus virginiana	Live oak	36	Viable	
133	quercus laurifolia	Laurel	12	Non viable	
134	quercus virginiana	Live oak	29	Viable	
135	quercus virginiana	Live oak	15	Viable	
136	quercus laurifolia	Laurel	11	Viable	
137	quercus falcata	Southern red oak	18	Viable	
138	quercus virginiana	Live oak	14	Non viable	
139	quercus virginiana	Live oak	36	Viable	
140	quercus nigra	Water oak	14	Viable	
141	quercus virginiana	Live oak	41	Viable	
142	quercus laurifolia	Laurel	14	Viable	
143	quercus laurifolia	Laurel	15	Viable	
144	pinus taeda	Loblolly pine	11	Viable	
145	carya tomentosa	Hickory	11	Viable	
146	magnolia grandiflora	Southern magnolia	13	Viable	
147	pinus taeda	Loblolly pine	18	Viable	
148	pinus taeda	Loblolly pine	18	Non viable	
149	quercus virginiana	Live oak	22	Viable	remain
150	pinus taeda	Loblolly pine	22	Viable	
151	acer rubrum	Red maple	8	Viable	
152	pinus taeda	Loblolly pine	15	Viable	
153	pinus taeda	Loblolly pine	18	Viable	
154	pinus taeda	Loblolly pine	13	Viable	
155	pinus taeda	Loblolly pine	14	Viable	
156	quercus falcata	Southern red oak	13	Viable	
157	pinus taeda	Loblolly pine	12	Viable	
158	quercus falcata	Southern red oak	12	Viable	
159	pinus taeda	Loblolly pine	12	Viable	
160	quercus virginiana	Live oak	25	Viable	
161	quercus laurifolia	Laurel	20	Viable	
162	quercus nigra	Water oak	22	Non viable	
163	quercus nigra	Water oak	17	Viable	
164	quercus nigra	Water oak	14	Viable	
165	quercus virginiana	Live oak	26	Viable	
166	quercus virginiana	Live oak	28	Viable	
167	quercus virginiana	Live oak	20	Viable	

Presented by: A Cut Above Tree Care
 David Bradford
 ISA Certified Arborist

UWF Tree Inventory Report

168	pinus taeda	Loblolly pine	16	Viable	
169	pinus taeda	Loblolly pine	17	Viable	
170	quercus falcata	Southern red oak	18	Non viable	remain
171	quercus laurifolia	Laurel	8	Viable	
172	quercus falcata	Southern red oak	26	Non viable	remain
173	quercus laurifolia	Laurel	15	Viable	
174	quercus laurifolia	Laurel	18	Non viable	
175	quercus laurifolia	Laurel	13	Non viable	
176	quercus laurifolia	Laurel	13	Non viable	
177	quercus laurifolia	Laurel	20	Viable	
178	quercus laurifolia	Laurel	14	Viable	
179	quercus virginiana	Live oak	25	Viable	
ZONE 4					
Number	Specles	Common Name	DBH 4 1/2'	Condltion	Notes:
180	pinus taeda	Loblolly pine	17	Viable	
181	quercus virginiana	Live oak	27	Viable	
182	quercus nigra	Water oak	8	Viable	
183	pinus taeda	Loblolly pine	15	Viable	
184	quercus laurifolia	Laurel	15	Non viable	remain
185	quercus laurifolia	Laurel	17	Non viable	
186	quercus laurifolia	Laurel	25	Viable	remain
187	quercus laurifolia	Laurel	27	Non viable	remain
188	quercus virginiana	Live oak	26	Viable	
189	quercus virginiana	Live oak	18	Viable	
190	quercus virginiana	Co-dominant live oak	17	Viable	
191	Pinus strobus	Eastern white pine	9	Viable	
192	Magnolia tripetala	Umbrella magnolia	13	Viable	
193	pinus taeda	Loblolly pine	16	Viable	
194	pinus taeda	Loblolly pine	18	Viable	
195	quercus virginiana	Live oak	34	Viable	
196	quercus virginiana	Co-dominant live oak	18	Viable	
197	pinus taeda	Loblolly pine	23	Viable	
198	quercus laurifolia	Laurel	23	Viable	
199	quercus virginiana	Live oak	24	Viable	
200	quercus virginiana	Live oak	42	Viable	
201	quercus virginiana	Live oak	14	Viable	remain
ZONE 5					
Number	Specles	Common Name	DBH 4 1/2'	Condition	Notes:
202	pinus taeda	Loblolly pine	14	Viable	
203	Liquidambar styraciflua	Sweet gum	8	Viable	
204	quercus virginiana	Live oak	28	Viable	
205	quercus virginiana	Live oak	36	Viable	

Presented by: A Cut Above Tree Care

David Bradford

ISA Certified Arborist

UWF Tree Inventory Report

206	quercus virginiana	Co-dominant live oak	73	Viable	HERITAGE
207	quercus laurifolia	Laurel	18	Non viable	
208	quercus laurifolia	Laurel	20	Viable	
209	quercus laurifolia	Laurel	25	Viable	
210	quercus virginiana	Live oak	19	Viable	
211	quercus virginiana	Co-dominant live oak	32	Viable	
212	quercus virginiana	Live oak	18	Non viable	
213	quercus laurifolia	Laurel	14	Non viable	
214	quercus virginiana	Live oak	20	Viable	remain
215	quercus laurifolia	Laurel	22	Non viable	remain
216	quercus falcata	Southern red oak	15	Viable	
217	quercus falcata	Southern red oak	26	Viable	
218	pinus taeda	Loblolly pine	12	Viable	
219	quercus laurifolia	Laurel	18	Non viable	remain
220	quercus virginiana	Live oak	20	Non viable	remain
ZONE 6					
Number	Species	Common Name	DBH 4 1/2'	Condition	Notes:
221	quercus laurifolia	Laurel	16	Viable	
222	quercus laurifolia	Laurel	12	Viable	
223	quercus laurifolia	Laurel	10	Non viable	
224	pinus taeda	Loblolly pine	15	Non viable	
225	quercus virginiana	Live oak	14	Viable	
226	quercus virginiana	Live oak	13	Viable	
227	quercus laurifolia	Laurel	16	Non viable	
228	quercus falcata	Southern red oak	18	Non viable	
229	quercus laurifolia	Laurel	12	Non viable	
230	quercus nigra	Water oak	12	Viable	
231	magnolia grandiflora	Southern magnolia	13	Viable	remain
232	pinus taeda	Loblolly pine	13	Viable	
233	quercus falcata	Southern red oak	24	Non viable	
234	quercus laurifolia	Laurel	20	Viable	
235	quercus laurifolia	Laurel	19	Non viable	
236	quercus laurifolia	Laurel	18	Non viable	
237	quercus laurifolia	Laurel	24	Non viable	
238	quercus virginiana	Live oak	14	Non viable	
239	quercus virginiana	Live oak	25	Viable	
240	quercus laurifolia	Laurel	18	Non viable	
241	quercus laurifolia	Laurel	22	Viable	
242	quercus laurifolia	Laurel	22	Viable	
243	quercus laurifolia	Laurel	27	Non viable	
244	quercus laurifolia	Laurel	22	Non viable	
245	quercus laurifolia	Laurel	16	Viable	
246	quercus laurifolia	Laurel	23	Viable	

Presented by: A Cut Above Tree Care

David Bradford

ISA Certified Arborist

UWF Tree Inventory Report

247	quercus virginiana	Co-dominant live oak	67	Viable	HERITAGE
248	quercus virginiana	Live oak	22	Viable	
249	pinus taeda	Loblolly pine	15	Viable	
250	quercus falcata	Southern red oak	8	Viable	
251	pinus taeda	Loblolly pine	14	Viable	
ZONE 7					
Number	Species	Common Name	DBH 4 1/2'	Condition	Notes:
252	quercus nigra	Water oak	14	Non viable	remain
253	pinus taeda	Loblolly pine	18	Viable	
254	quercus laurifolia	Laurel	23	Non viable	
255	quercus virginiana	Live oak	55	Viable	
256	quercus virginiana	Live oak	26	Viable	
257	quercus laurifolia	Laurel	16	Non viable	
258	quercus laurifolia	Laurel	17	Viable	
259	quercus laurifolia	Laurel	18	Non viable	
260	quercus falcata	Southern red oak	27	Viable	
261	quercus falcata	Southern red oak	15	Viable	
262	quercus laurifolia	Laurel	17	Viable	
263	pinus taeda	Loblolly pine	14	Viable	
264	quercus laurifolia	Laurel	13	Non viable	
265	quercus virginiana	Co-dominant live oak	41	Viable	
266	quercus laurifolia	Laurel	13	Non viable	
267	quercus virginiana	Live oak	13	Viable	
ZONE 8					
Number	Species	Common Name	DBH 4 1/2'	Condition	Notes:
268	quercus laurifolia	Laurel	17	Viable	
269	quercus laurifolia	Laurel	14	Viable	
270	quercus falcata	Southern red oak	16	Viable	
271	quercus virginiana	Co-dominant live oak	32	Viable	
272	quercus virginiana	Live oak	16	Viable	
273	quercus virginiana	Live oak	22	Viable	
274	quercus virginiana	Live oak	19	Non viable	
275	quercus laurifolia	Laurel	16	Viable	
276	quercus laurifolia	Laurel	13	Viable	
277	quercus laurifolia	Laurel	14	Viable	
278	quercus virginiana	Live oak	21	Viable	
279	quercus virginiana	Live oak	17	Viable	
280	pinus taeda	Loblolly pine	14	Viable	
281	pinus taeda	Loblolly pine	16	Viable	
282	castanea dentata	American chestnut	9	Viable	

Presented by: A Cut Above Tree Care
 David Bradford
 ISA Certified Arborist

UWF Tree Inventory Report

ZONE 9					
Number	Species	Common Name	DBH 4 1/2'	Condition	Notes:
283	quercus falcata	Southern red oak	16	Viable	
284	quercus virginiana	Live oak	38	Viable	
285	quercus virginiana	Live oak	30	Viable	
286	quercus virginiana	Live oak	21	Viable	
287	quercus virginiana	Live oak	25	Non viable	
288	pinus taeda	Loblolly pine	19	Viable	
289	quercus laurifolia	Laurel	24	Viable	
290	quercus virginiana	Co-dominant live oak	19	Viable	
291	quercus falcata	Southern red oak	15	Viable	
292	quercus laurifolia	Co-dominant laurel	14	Viable	
293	quercus laurifolia	Laurel	13	Non viable	
ZONE 10					
Number	Species	Common Name	DBH 4 1/2'	Condition	Notes:
294	quercus laurifolia	Laurel	16	Viable	
295	quercus virginiana	Live oak	12	Viable	
296	quercus virginiana	Live oak	16	Viable	
297	pinus taeda	Loblolly pine	18	Viable	
298	magnolia grandiflora	Southern magnolia	9	Viable	
299	quercus laurifolia	Laurel	28	Viable	
300	quercus virginiana	Co-dominant live oak	51	Viable	
301	quercus virginiana	Live oak	26	Viable	remain
ZONE 11					
Number	Species	Common Name	DBH 4 1/2'	Condition	Notes:
302	quercus falcata	Co-dominant Southern red	13	Viable	
303	quercus laurifolia	Laurel	24	Viable	
304	quercus laurifolia	Laurel	15	Viable	
305	pinus taeda	Loblolly pine	17	Viable	
ZONE 12					
Number	Species	Common Name	DBH 4 1/2'	Condition	Notes:
306	quercus virginiana	Live oak	16	Viable	
307	pinus taeda	Loblolly pine	17	Viable	
308	Quercus palustris	Pin oak	11	Viable	
309	quercus laurifolia	Laurel	17	Viable	remain
310	pinus taeda	Loblolly pine	13	Viable	
311	pinus taeda	Loblolly pine	15	Viable	
312	pinus taeda	Loblolly pine	12	Viable	

Presented by: A Cut Above Tree Care
 David Bradford
 ISA Certified Arborist

1/20/2015

UWF Tree Inventory Report

313	pinus taeda	Loblolly pine	14	Viable	
314	pinus taeda	Loblolly pine	17	Non viable	
315	pinus taeda	Loblolly pine	14	Viable	
316	Quercus palustris	Pin oak	13	Viable	
317	pinus taeda	Loblolly pine	17	Viable	
318	pinus taeda	Loblolly pine	14	Viable	

Presented by: A Cut Above Tree Care
David Bradford
ISA Certified Arborist